



LEGAL DESCRIPTION
BOUNDARY LINE ADJUSTMENT
REVISED LOT C4

LOT C4 OF THE HOMESTEAD VIEW PLAT (P-06-07), AS RECORDED SEPTEMBER 16, 2008, IN BOOK 11 OF PLATS, PAGES 169 AND 170, UNDER AUDITOR'S FILE NUMBER 200809160020, RECORDS OF KITTITAS COUNTY, STATE OF WASHINGTON, EXCEPT THAT PORTION DESCRIBED AS FOLLOWS:

BEGINNING AT THE NORTHWESTERLY POINT OF SAID LOT C4; THENCE NORTH 75°50'08" EAST, 18.19 FEET TO THE BEGINNING OF A CURVE TO THE LEFT HAVING A RADIUS OF 175.00 FEET; THENCE ALONG SAID CURVE TO THE LEFT AN ARC LENGTH OF 18.33 FEET, THROUGH A CENTRAL ANGLE OF 6°00'03" TO THE TRUE POINT OF BEGINNING OF SAID LINE; THENCE CONTINUING ALONG SAID CURVE TO THE LEFT HAVING A RADIUS OF 175.00 FEET; THENCE ALONG SAID CURVE TO THE LEFT AN ARC LENGTH OF 156.36 FEET, THROUGH A CENTRAL ANGLE OF 51°11'37"; THENCE NORTH 18°38'28" EAST, 63.42 FEET TO THE BEGINNING OF A CURVE TO THE LEFT HAVING A RADIUS OF 285.00 FEET; THENCE ALONG SAID CURVE TO THE LEFT AN ARC LENGTH OF 31.51 FEET, THROUGH A CENTRAL ANGLE OF 6°20'05"; THENCE SOUTH 89°49'50" EAST, 435.08 FEET; THENCE SOUTH 00°10'10" WEST, 449.80 FEET; THENCE NORTH 63°08'42" WEST ALONG THE CENTERLINE OF EASEMENT "R" OF SAID PLAT, 392.33 FEET; THENCE NORTH 70°59'22" WEST, ALONG THE CENTERLINE OF SAID EASEMENT "R", 230.46 FEET TO THE TRUE POINT OF BEGINNING AND TERMINUS OF SAID DESCRIBED LINE.

ALL SITUATED IN SECTION 23, TOWNSHIP 20 NORTH, RANGE 15 EAST, W.M., KITTITAS COUNTY, STATE OF WASHINGTON.

CONTAINING 21.65 ACRES

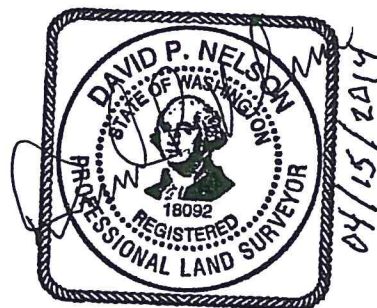

Western Washington Division

165 NE Juniper St., Ste 201, Issaquah, WA 98027
98922

Phone: (425) 392-0250 Fax: (425) 391-3055
674-7419

Eastern Washington Division

108 East 2nd Street, Cle Elum, WA

Phone: (509) 674-7433 Fax: (509)